

# clinell<sup>®</sup>

[www.clinell.com.au](http://www.clinell.com.au)



## CLINELL UNIVERSAL RANGE

Hospital grade surface disinfectant wipes  
with dual disinfection and detergent action

Clinell Universal Wipes contain a patented formula with wide spectrum antimicrobial activity, including MRSA and VRE. A mix of biocides, with different mechanisms of action, designed to mitigate against bacterial resistance.

# UNIVERSAL WIPES

Clinell Universal Wipes provide a single universal product that cleans and disinfects in one easy step.



## COMPATIBLE WITH A WIDE RANGE OF SURFACES AND EQUIPMENT

With a near neutral pH, they are ideal for use on mattresses and safe to use on rubber. Approved by leading manufacturers for equipment and surface disinfection. With Clinell Universal Wipes there is no drying damage to surfaces, which commonly occurs with use of 70% alcohol wet wipes or bleach.

## RANGE OF USE

Suitable for use on surfaces, including table tops, taps, door handles, mattresses, desks, computer keyboards, chairs, ledges etc. Broad compatibility with materials used throughout healthcare environments.

## TRUSTED BRAND

Developed by doctors, widely used in the UK's NHS. Clinell is the UK's leading infection control brand & hospitals preferred choice in their fight against superbugs.

## ANTIMICROBIAL ACTIVITY

Hospital grade disinfectant wipes which act as both a disinfectant and detergent for surfaces. They contain a patented formula with wide spectrum antimicrobial activity including MRSA and VRE. A mix of biocides, with different mechanisms of action, designed to mitigate against bacterial resistance.

## How to clean surfaces effectively



1. Perform a risk assessment, wear recommended PPE. Take one wipe from the pack.

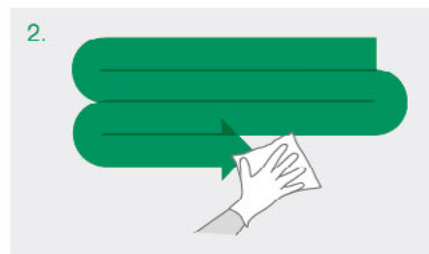

2. Working from clean to dirty, wipe in an 'S' shaped pattern, taking care not to go over the same area twice.

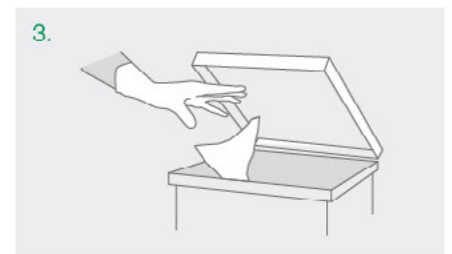

3. Change wipe if it becomes dry or soiled and dispose of in the appropriate waste bin. Let the surface air dry.

PRODUCT	UNIT OF ISSUE	ORDER CODE
Universal Wipes 40	Pack of 40	CW40AUS
Universal Wipes 200	Pack of 200	CW200AUS
Universal Wipes Tub 100	Tub of 100	CWTUB100AUS
Universal Wipes Tub Refill 100	Refill of 100	CWTUB100RAUS
Universal Wipes Bucket 225	Bucket of 225	CWBUC225AUS
Universal Wipes Bucket Refill 225	Refill of 225	CWBUC225RAUS
Wall Dispenser for CW200AUS	Single Unit	CWD
Wall Dispenser for CWTUB100AUS	Single Unit	CWTUB100D
Wall Dispenser for CWBUC225AUS	Single Unit	CWBUC225D

USE DISINFECTANTS SAFELY. ALWAYS READ THE LABEL AND PRODUCT INFORMATION BEFORE USE.

ALWAYS FOLLOW MEDICAL EQUIPMENT MANUFACTURER'S CLEANING PROCEDURES AND GUIDELINES.



AUST-L 178363

JBN17582